

# Canopy Kit

## Quick Start Guide

# AP700 Series

**A** \* Bracket x 2

**B-1** \* Wire Mount x 4

**B-2** \* Tapping Screws x 8

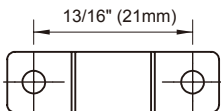
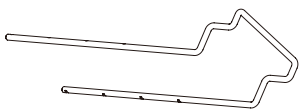

B-1 scale 1:1

## Installation Instructions

Make sure to unplug the unit when installing accessories. Only turn the unit back on when the light has been properly mounted.

33"~36" (840~915mm)

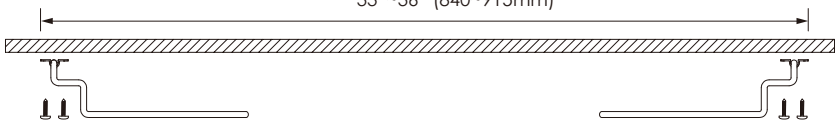

1. Mount the brackets onto the canopy.

\* Note: For canopies under 33", the brackets must be mounted with the unit already attached.

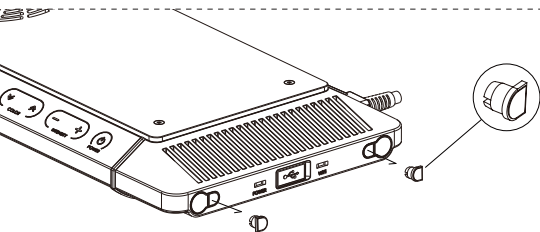

2. Remove the the rubber stoppers on both sides of the light.

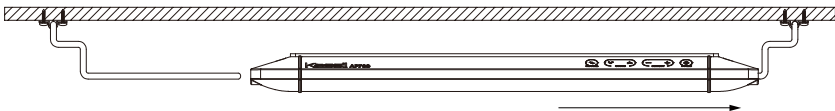

3. Slide AP700 all the way into one side.

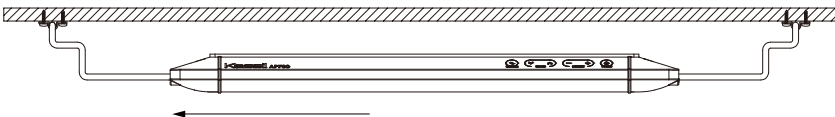

4. Slide AP700 onto the other bracket.  
Make sure the unit is centered and secure.